



**PLASTICA ALFA**  
INNOVATION & WATER TECHNOLOGIES

# BLULINE PLUS

Raccordi a compressione  
Compression fittings

Technical Catalogue





I raccordi a compressione **Blu Line Plus** rappresentano l'evoluzione dei raccordi a compressione Plastica Alfa: l'installazione non richiede lo smontaggio completo del raccordo (**push-in**). Sono stati progettati e testati per garantire una pressione di esercizio ammissibile (**PFA/PN**) tra **16 a 18 bar**. Vengono impiegati per collegare tubi in polietilene (PEBD, PEMD e PEAD) e in PPR per la distribuzione di fluidi in pressione (fino a PFA 16) e non; in particolare, sono usati per il trasporto di acqua potabile negli acquedotti e negli impianti civili, nell'irrigazione, negli impianti antincendio, negli impianti geotermici, per il convogliamento di acque reflue e industriali, per la distribuzione di aria compressa.

*Blu Line Plus compression fittings represent the evolution of Plastica Alfa compression fittings: no disassembly is required for installation (push-in). They are designed and tested to grant the allowable operating pressure (PFA/PN) between 16 up to 18 bar. Blu Line Plus fittings are used to connect polyethylene (LDPE, MDPE and HDPE) and PPR pipes to supply pressurized (up to PFA 16) and not pressurized fluids; they are especially used for drinking water supply in aqueducts and civil installations, irrigation, firefighting systems, geothermal systems, to convey waste and industrial water, compressed air.*



**Corpo**  
Body

Polipropilene nero ad alto impatto stabilizzato UV e con elevata stabilità all'invecchiamento.  
*High impact black Polypropylene, UV stabilized with long term heat aging.*



**Anello di spinta**  
Thrust ring

Polipropilene nero ad alto impatto stabilizzato UV  
*High impact black Polypropylene, UV stabilized with long term heat aging.*



**Ghiera**  
Nut

Polipropilene blu ad alto impatto, stabilizzato UV  
*High impact Blue Polypropylene stabilized to UV ray exposition*



**Anello di rinforzo\***  
Reinforcing ring

Acciaio inox "AISI 430"  
*Stainless steel "AISI 430"*



**Anello di Graffaggio**  
Clinching Ring

Resina acetica (POM)  
*Acetal resin (POM)*



**Guarnizione**  
Gasket

Gomma nitrilica nera (NBR)  
*Black nitrile rubber (NBR)*

#### TEMPERATURA E PRESSIONE D'ESERCIZIO

WORKING TEMPERATURE AND PRESSURE

Ø 20÷125

**20°C-18 bar, 45°C-10.8 bar, 70°C-3,4bar**

Ø 3"- 4" Filettato femmina/female threaded

**20°C-10bar, 45°C-6.7bar, 70°C-2bar**

#### PRESSIONE DI ESERCIZIO AMMISSIBILE PFA (PN) IN BAR

ALLOWABLE OPERATING PRESSURE PFA (PN) IN BAR

Ø 20÷125 = **16**

Ø 3"- 4" Filettato femmina/female threaded = **10**

#### RANGE DI TEMPERATURE

TEMPERATURE RANGE

-10 °C ÷ 60 °C

#### PRESSIONE ESERCIZIO MASSIMA AMMISSIBILE PMA IN BAR

ALLOWABLE MAXIMUM OPERATING PRESSURE PMA IN BAR

Ø 20÷125 = **20**

Ø 3"- 4" Filettato femmina/female threaded = **12.5**

#### PRESSIONE DI PROVA AMMISSIBILE PER IL SITO (PEA) IN BAR

ALLOWABLE SITE PRESSURE (PEA) IN BAR

Ø 20÷125 = **24**

Ø 3"- 4" Filettato femmina/female threaded = **15**

\* La presenza dell'anello di rinforzo conferisce al filetto femmina una garanzia aggiuntiva in termini di resistenza alle pressioni di esercizio, in particolar modo ad elevate temperature e nel lungo termine.

\* *The reinforcing ring gives to the female thread an additional guarantee in terms of resistance to working pressure, especially at high temperatures and on the long term.*

#### IDONEITÀ AL CONTATTO CON ACQUA POTABILE

REGULATIONS FOR DRINKING WATER

DM 174-06/04/2004 (Italy), DM 23/04/2009 e Reg. UE n° 10/2011, W270 and KTW (Germany),

ATA (Netherlands), Global Mark (Australia), ACS (France).

#### NORME DI RIFERIMENTO

REFERENCE STANDARDS

**Tubi/Pipes:** UNI EN 12201, ISO 11922-1, DIN 8074, AS/NZS 4130, BS 6572, BS 6730, ISO 4427, UNI 7990, ISO 12162.

**Filetti BSP/BSP Threads:** UNI EN 10226 (ISO 7-1), BS 21, AS 1722.1

**Filetti NPT/NPT threads:** ANSI-ASME B1.20.1

**Flange/Flanges:** UNI EN1092-1, ISO 7005-1, DIN 2501.1, BS 4504

**Tubi scanalati/Grooved pipes (tipo Victaulic/Victaulic type):** ANSI/AWWA C 606-87

**Prove/Tests:** ISO 17885 (ex ISO 14236), DIN 8076-3, AS/NZS 4129, BRL K534/03 –UNI, ISO 3501, ISO 3503, ISO 3458, ISO 3459, VP609

#### CERTIFICATI DI PRODOTTO

APPROVALS



**KIWA**  
Netherlands and Italy



**GOST**  
Russia



**ROMANIA**

**CTPC**  
Romania

## Schema di Montaggio

### Assembly Instructions

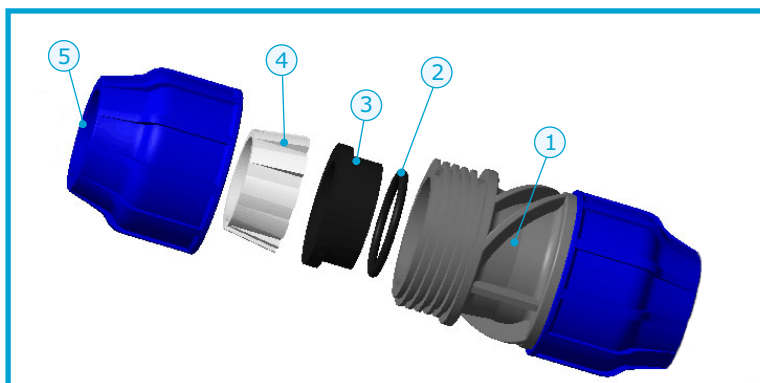

#### COMPONENTI - COMPONENTS

1. CORPO - Body
2. GUARNIZIONE - o ring
3. ANELLO DI SPINTA - Thrust ring
4. ANELLO DI GRAFFAGGIO - Clinching ring
5. GHIERA - Nut

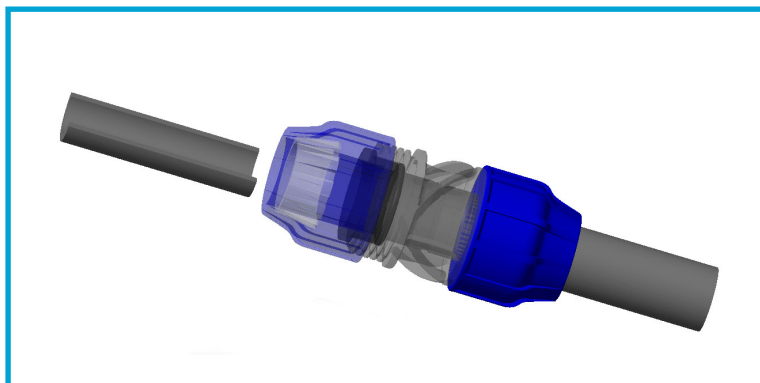

#### 1

Tagliare il tubo ortogonalmente all'asse e smussare la sua estremità.

Cut the pipe squarely and chamfer the ends.

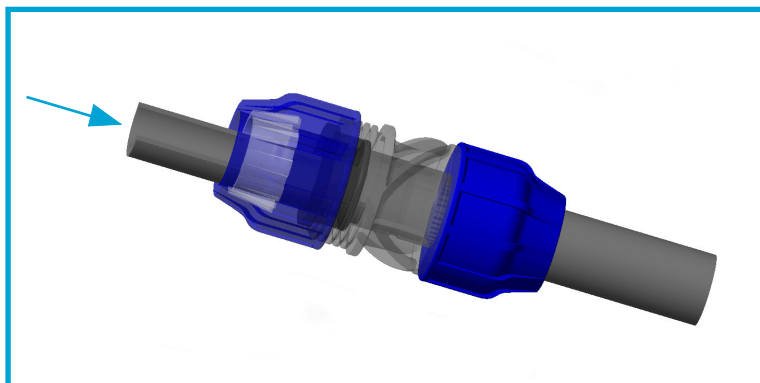

#### 2

Allentare la ghiera per agevolare il totale allargamento dell'anello di graffaggio e permettere un più facile inserimento del tubo.

La ghiera e i componenti interni del raccordo (anello di spinta e o-ring) non devono essere estratti dal corpo.

Loosen the nut to facilitate a total opening of clinching ring and to allow an easier insertion of the pipe.

The nut and the inside components (thrust ring and o-ring) must be not extracted from the body.

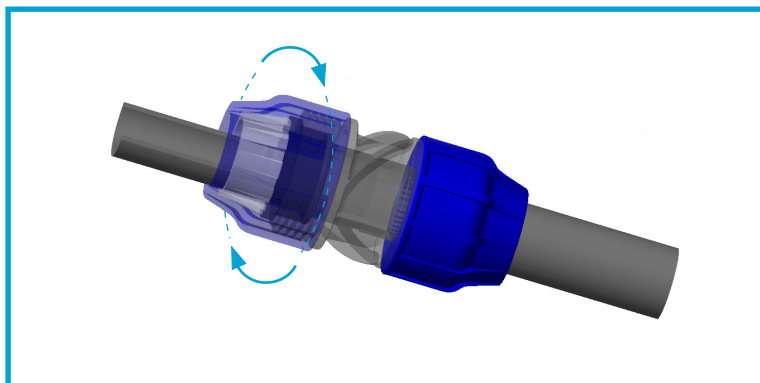

#### 3

Applicando una leggera forza spingere il tubo fino a portarlo a battuta all'interno del corpo del raccordo.

Gently push the pipe into the fitting body up to the beat.

#### 4

Ruotare la ghiera fino a stringerla del tutto. Il raccordo è pronto per l'utilizzo.

Screw the nut completely. The fitting is ready for use.

## Manicotto

Coupling - Manchon - manguito

**53910**

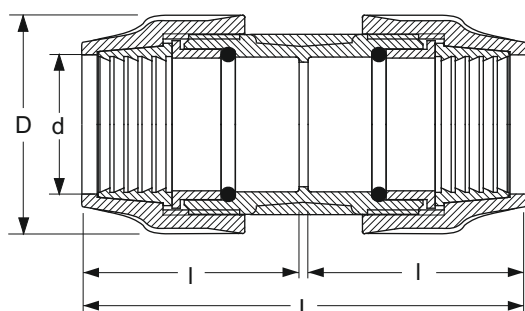
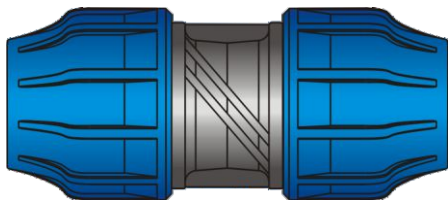

d	D	L	I
20	47	125	61
25	54	137	66.5
32	63.5	147.5	72
40	76	175.5	84
50	91.5	200	97.5
63	110.5	230	112
75	127.5	254	124.5
90	150	312	156.5
110	176.5	370.5	182
125	207.5	506	254

## Manicotto ridotto

Reducing Coupling - Manchonreduit - Manguito Reducido

**53920**

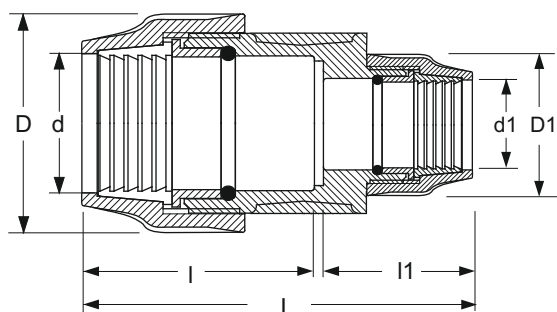
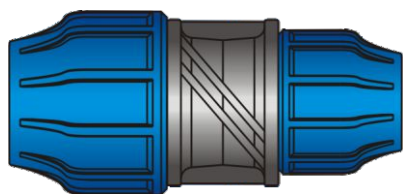

dxd1	D	D1	L	I	I1
25-20	54	47	133	66	61
32-20	63.5	47	138	74	61
32-25	63.5	54	143	74	67
40-32	76	63.5	170	85	76
50-32	91.5	63.5	183	98	76
50-40	91.5	76	187	98	85
63-32	110.5	63.5	196	113.5	76
63-40	110.5	76	203	113.5	85
63-50	110.5	91.5	218	113.5	98
75-50	127.5	91.5	232	130	98
75-63	127.5	110.5	243	130	113.5
90-63	150	110.5	282	156	140
90-75	150	127.5	300	156	140
110-75	176.5	127.5	331	182	140
110-90	176.5	150	345	182	156

## Raccordo maschio

55910

Male Adaptor - Raccord Male - Empalme Macho

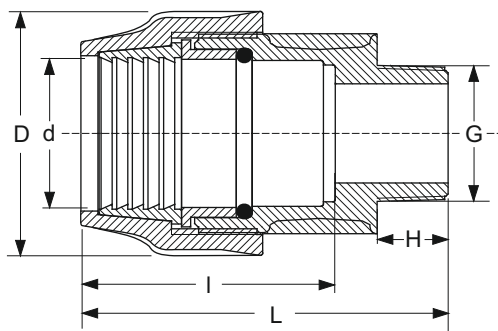
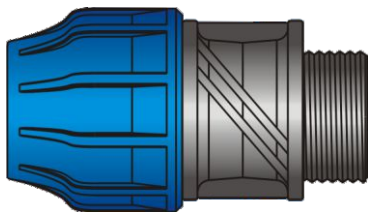

dxG	D	L	I	H
20x1/2"	47	94.5	70.5	18
20x3/4"	47	94.5	70.5	18
25x1/2"	54	100	78.5	18
25x3/4"	54	100	78.5	18
25x1"	54	102	78.5	20
32x3/4"	63.5	106	83.5	18
32x1"	63.5	108	83.5	20
32x1 1/4"	63.5	109.5	83.5	21.5
40x1"	76	128	100	20
40x1 1/4"	76	131.5	100	23.5
40x1 1/2"	76	131.5	100	23.5
50x1 1/2"	91.5	145	114	23.5
50x2"	91.5	147.5	114	26
63x1 1/2"	110.5	157	127.5	23.5
63x2"	110.5	159.5	127.5	26
63x2 1/2"	110.5	159.5	127.5	26
75x2"	127.5	176	143	26
75x2 1/2"	127.5	176	143	26
75x3"	127.5	178	143	28
90x2"	150	217	182.5	26
90x2 1/2"	150	219	182.5	28
90x3"	150	226	182.5	35
90x4"	150	234	182.5	43
110x3"	176.5	252	211	35
110x4"	176.5	263	211	43
125x4"	207.5	350	252	43
125x5"	207.5	352	252	46

## Raccordo femmina

55920

Female Adaptor - Raccord femelle - Empalme Hembra

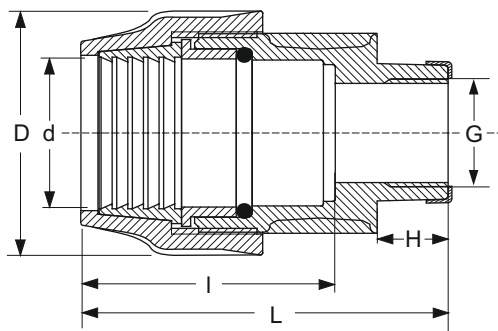
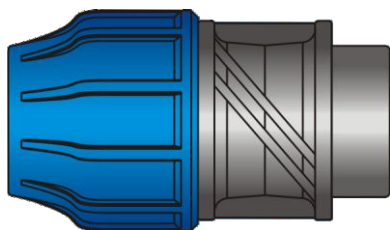

dxG	D	L	I	H
20x1/2"	47	94.5	70.5	18
20x3/4"	47	94.5	70.5	18
25x1/2"	54	100	78.5	18
25x3/4"	54	100	78.5	18
25x1"	54	102	78.5	20
32x3/4"	63.5	106	84.5	17
32x1"	63.5	108.5	84.5	19.5
32x1 1/4"	63.5	110	84.5	21
40x1"	76	128	100	20
40x1 1/4"	76	131.5	100	23.5
40x1 1/2"	76	131.5	100	23.5
50x1 1/2"	91.5	145	114	23.5
50x2"	91.5	147.5	114	26
63x1 1/2"	110.5	157	127.5	23.5
63x2"	110.5	159.5	127.5	26
75x2"	127.5	176	143	26
75x2 1/2"	127.5	176	143	26
75x3"	127.5	178	143	28
90x3"	150	226	182.5	35
110x3"	176.5	256	211	35
110x4"	176.5	264	211	43



Dal ø 2" al ø 4" con anello di rinforzo di serie. Anello opzionale per tutte le misure inferiori  
 Standard with reinforcing ring from ø 2" to ø 4". Optional reinforcing ring for lower dimensions

## Raccordo Alfarapid

**55940**

Alfarapid Adaptor - Raccord Alfarapid - Conector Alfarapid

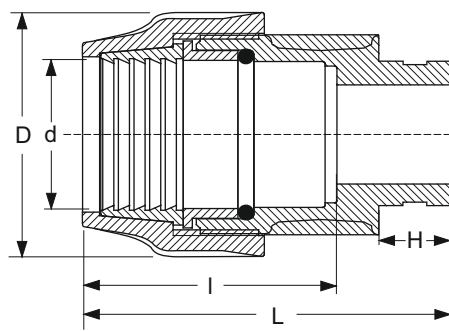
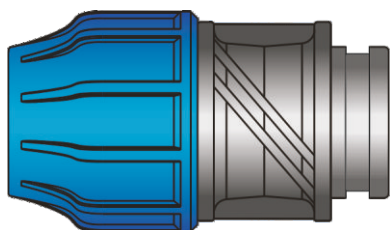

dxG	D	L	I	H
50x2"	91.5	161	114	40
63x2"	110.5	182	127.5	40
75x3"	127.5	191	143	40
90x3"	150	230.5	182.5	40
90x4"	150	230.5	182.5	40
110x4"	176.5	262	211	40
125x4"	176.5	345	254	40

## Gomito a 90°

**56950**

90° Elbow - Coude 90° - Codo 90°

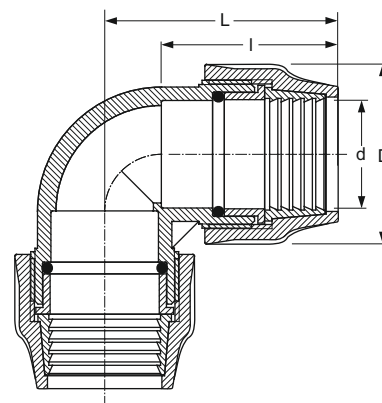
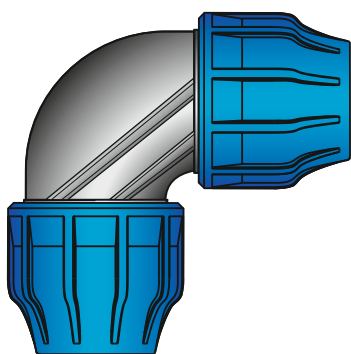

d	D	L	I
20	47	73	59
25	54	81	67.5
32	63.5	90	72
40	76	107.5	85.5
50	91.5	123	97.5
63	110.5	147	112.5
75	127.5	168	129.5
90	150	201	153.5
110	176.5	240	183.5



**Gomito a 90° filettato femmina****56935**

90° Female threaded elbow - Coude 90° taraudé - Codo 90° roscado hembra

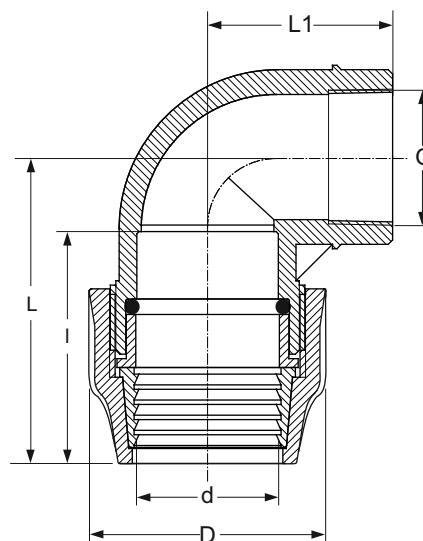
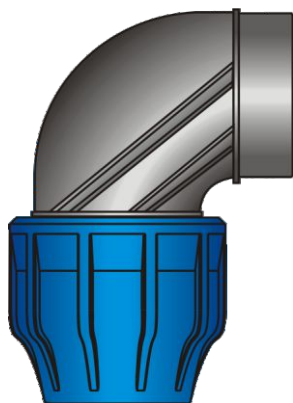

dxG	D	L	I	L1
20x1/2"	47	71.5	61.5	43
20x3/4"	47	71.5	61.5	44
25x1/2"	54	81	42	50
25x3/4"	54	81	42	51.5
25x1"	54	81	42	53.5
32x3/4"	63.5	90	72.5	52
32x1"	63.5	90	72.5	53.5
40x1"	76	107	87	63
40x1 1/2"	76	107	87	66.5
50x1 1/2"	91.5	123	97.5	72.5
50x2"	91.5	123	97.5	74.5
63x2"	110.5	147	112.5	84
75x2"	127.5	168	129	100
75x2 1/2"	127.5	168	129	100
90x2 1/2"	150	201	153.5	114
90x3"	150	201	153.5	115
110x3"	176.5	240	183.5	126
110x4"	176.5	240	183.5	128

Dal  $\varnothing 2"$  al  $\varnothing 4"$  con anello di rinforzo di serie. Anello opzionale per tutte le misure inferiori  
 Standard with reinforcing ring from  $\varnothing 2"$  to  $\varnothing 4"$ . Optional reinforcing ring for lower dimensions





## Gomito a 90° filettato maschio

**56925**

90° male threaded elbow - Coude 90° fileté - Codo 90° roscado macho

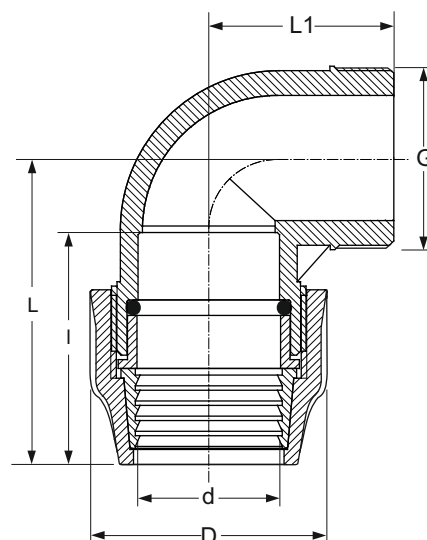
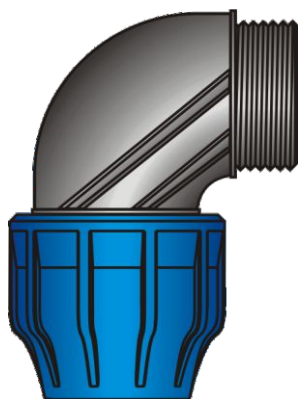

dxG	D	L	I	L1
20 x 1/2"	47	71.5	61.5	43
20 x 3/4"	47	71.5	61.5	44
25 x 1/2"	54	81	42	50
25 x 3/4"	54	81	42	51.5
25 x 1"	54	81	42	53.5
32 x 3/4"	63.5	90	72.5	54
32 x 1"	63.5	90	72.5	56
32 x 1 1/4"	63.5	90	72.5	58
40 x 1"	76	107	87	63
40 x 1 1/4"	76	107	87	65
40 x 1 1/2"	76	107	87	66.5
40 x 2"	76	107	87	68
50 x 1 1/4"	91.5	123	97.5	72.5
50 x 1 1/2"	91.5	123	97.5	74.5
50 x 2"	91.5	123	97.5	74.5
63 x 1 1/2"	110.5	147	112.5	84
63 x 2"	110.5	147	112.5	84
63 x 2 1/2"	110.5	147	112.5	85
75 x 2"	127.5	168	129.5	100
75 x 2 1/2"	127.5	168	129.5	100
75 x 3"	127.5	168	129.5	102
90 x 3"	150	201	153.5	114
90 x 4"	150	201	153.5	114
110 x 4"	176.5	240	183.5	128

## Tee a 90°

90° Tee - Tè 90° - Te 90°

54910

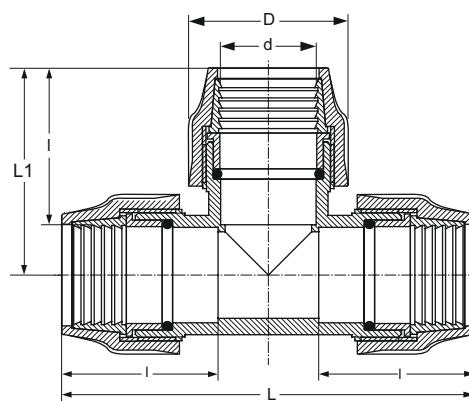
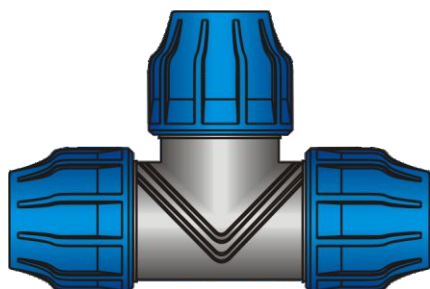

dx dx dx	D	L	I	L1
20x20x20	47	147	61	73
25x25x25	54	161	67	80.5
32x32x32	63.5	179	72.5	89.5
40x40x40	76	214	85.5	107
50x50x50	91.5	250	98.5	125
63x63x63	110.5	294	112.8	147
75x75x75	127.5	333	128.5	166.5
90x90x90	150	404	153	402
110x110x110	176.5	480	183.5	240

## Tee 90° filettato femmina

90° fReducing Tee - Tè 90° réduit - Te 90° reducida

54920

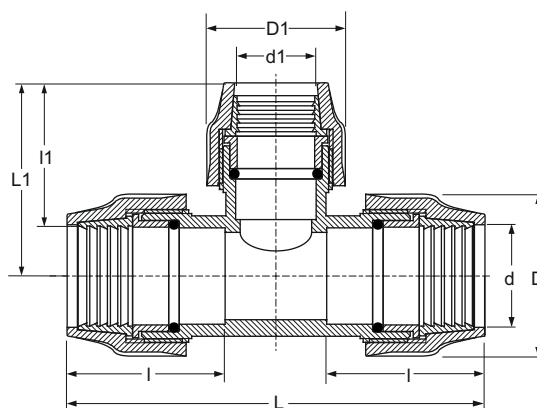
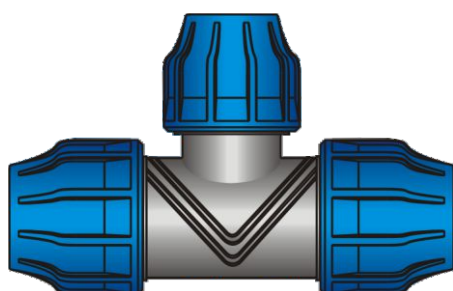

dx d1 dx	D	D1	L	I	L1	I1
20x25x20	47	54	144	61	-	-
25x20x25	54	47	161	67	78	61
32x25x32	63.5	54	179	72.5	85	68
40x32x40	76	63.5	214	85.5	99	72
50x25x50	91.5	54	250	98.5	-	-
50x32x50	91.5	63.5	250	98.5	106	78
50x40x50	91.5	76	250	98.5	116	86
63x25x63	110.5	54	294	112.8	122	84
63x32x63	110.5	63.5	294	112.8	118	81
63x40x63	110.5	76	294	112.8	138	100.5
63x50x63	110.5	91.5	294	112.8	137	103
75x63x75	127.5	110.5	333	128.5	-	-
90x75x90	150	127.5	404	153	-	-
110x90x110	176.5	150	480	183.5	-	-

## Tee 90° filettato maschio

**54930**

90° male threaded Tee - Tè 90° filettè - Te 90° roscada macho

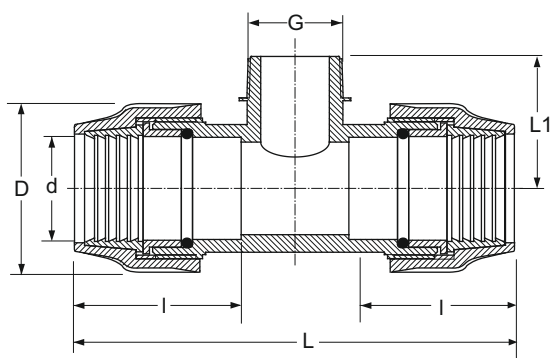
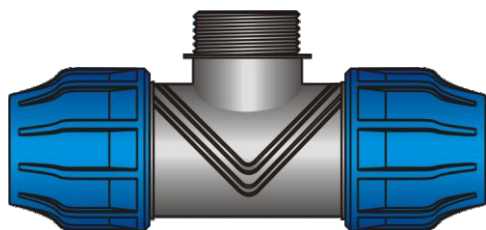

dxGxd	D	L	I	L1
20 x 1/2"	47	145	59	45
20 x 3/4"	47	145	59	45
25 x 1/2"	54	162	68	50
25 x 3/4"	54	162	68	51
25 x 1"	54	162	68	51
32 x 3/4"	63.5	180.5	72.5	56
32 x 1"	63.5	180.5	72.5	58
40 x 1"	76	212	86	66
40 x 1 1/4"	76	212	86	66
40 x 1 1/2"	76	212	86	68
50 x 1 1/2"	91.5	250	98	72
50 x 2"	91.5	250	98	72
63 x 2"	110.5	295	113	85
63 x 2 1/2"	110.5	295	113	87
75 x 2"	127.5	333	128.5	97
75 x 2 1/2"	127.5	333	128.5	97
75 x 3"	127.5	333	128.5	100
90 x 3"	150	404	153	112
90 x 4"	150	404	153	114
110 x 3"	176.5	480	183.5	130.5
110 x 4"	176.5	480	183.5	135

## Tee 90° filettato femmina

**54940**

90° female threaded Tee - Tè 90° taraudè - Te 90° roscada hembra

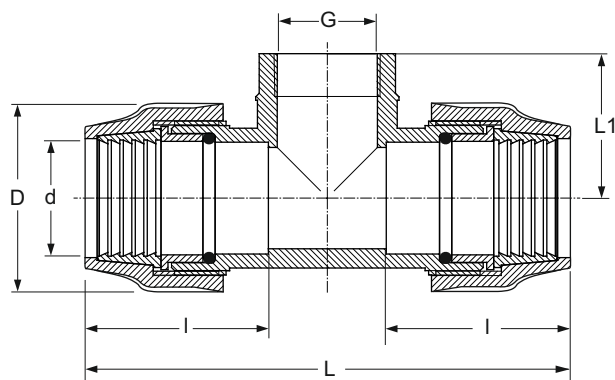
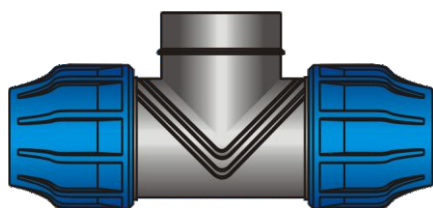

dxGxd	D	L	I	L1
20 x 1/2"	47	145	59	45
20 x 3/4"	47	145	59	45
25 x 1/2"	54	162	68	45
25 x 3/4"	54	162	68	46
25 x 1"	54	162	68	49
32 x 3/4"	63.5	180.5	72.5	52
32 x 1"	63.5	180.5	72.5	53
40 x 1"	76	212	86	60
40 x 1 1/4"	76	212	86	62
40 x 1 1/2"	76	212	86	63
50 x 1 1/4"	91.5	250	98	72
50 x 1 1/2"	91.5	250	98	72
63 x 2"	110.5	295	113	85
75 x 2"	127.5	333	128.5	97
75 x 2 1/2"	127.5	333	128.5	97
75 x 3"	127.5	333	128.5	100
90 x 3"	150	404	153	112
90 x 4"	150	404	153	114
110 x 3"	176.5	480	183.5	130.5
110 x 4"	176.5	480	183.5	135

Dal ø 2" al ø 4" con anello di rinforzo di serie. Anello opzionale per tutte le misure inferiori  
Standard with reinforcing ring from ø 2" to ø 4". Optional reinforcing ring for lower dimensions



**Tappo terminale****54941**

End Cap - Bouchon de fermeture - Tapón Terminal

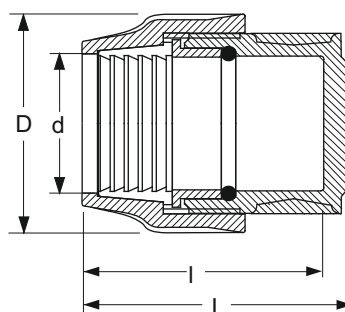
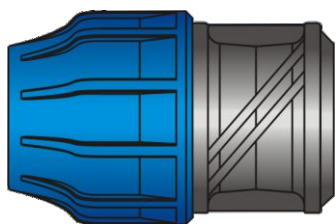

d	D	L	l
20	47	79	71.5
25	54	84	78.5
32	63.5	89.5	83.5
40	76	109.5	100
50	91.5	123	113
63	110.5	139.5	130
75	127.5	155	145
90	150	192	181
110	176.5	222	210

## Raccordo Flangiato

**55930**

Flanged adaptors - Raccords avec brides - Conector con brida

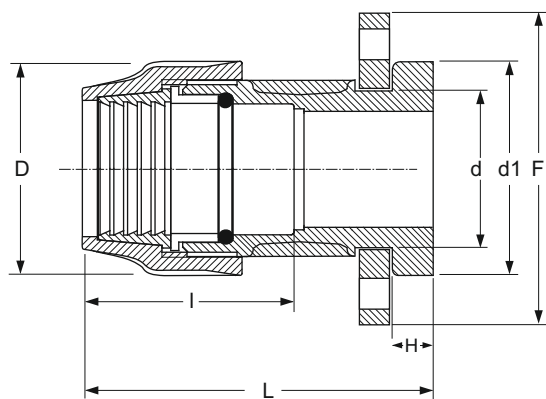
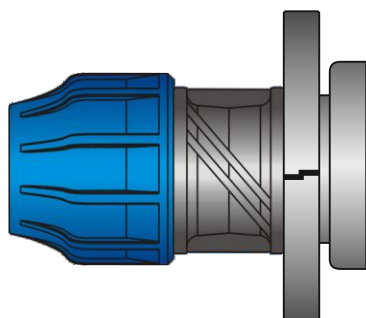

	D	L	I	H	d	d1	F
50x1½"	91	163	114	17,5	59,5	89,5	152
63x2"	107	184	127,5	17,5	77	103	165
75x2½"	125	197	143	19,5	88	122	185
90x3"	150	237	182,5	20	108	138	200
110x4"	176	276,5	211	24	131	158	220

## Gomito Flangiato

**56980**

90° Flanged Elbow - 90° Coude avec brides - Codo 90° con brida

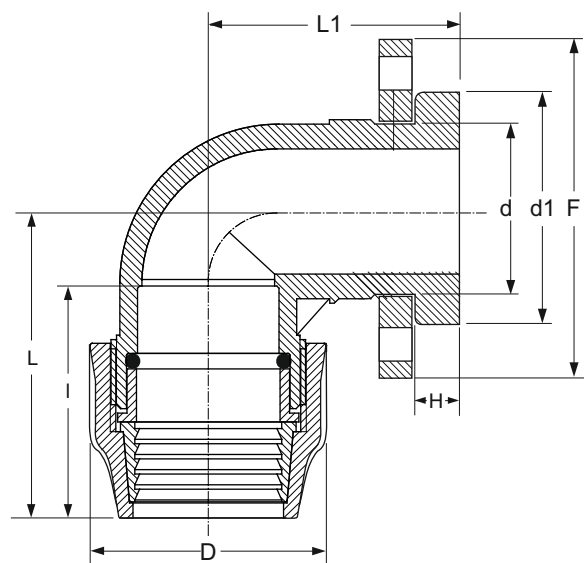
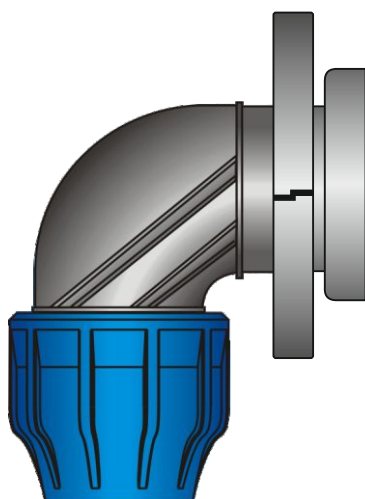

	D	L	I	L1	H	d	d1	F
50x1½/2	91.5	123	97.5	72.5	17,5	59,5	89,5	152
50x2"	91.5	123	97.5	74.5	17,5	77	103	165
63x2"	110.5	147	112.5	84	17,5	77	103	165
75x2"	127.5	168	129	100	17,5	77	103	165
75x2½/2	127.5	168	129	100	19,5	88	122	185
90x2½/2	150	201	153.5	114	19,5	88	122	185
90x3"	150	201	153.5	150	20	108	138	200
110x3"	176.5	240	183.5	126	20	108	138	200
110x4"	176.5	240	183.5	128	24	131	158	220

**Tee Flangiata**

**54980**

90° Flanged Elbow - 90° Coude avec brides - Codo 90° con brida

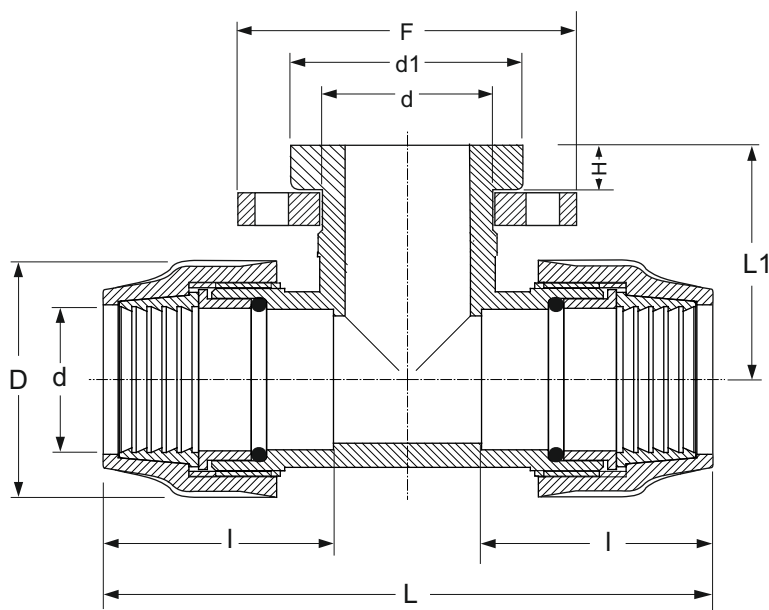

dxG	D	L	I	L1	H	d	d1	F
63x2"	110.5	295	112.5	84	17,5	77	103	165
75x2"½	127.5	333	129	100	19,5	88	122	185
90x3"	150	404	153.5	150	20	108	138	200
90x4"	150	404	153,5	140	24	131	158	220
110x3"	176.5	480	183.5	126	20	108	138	200
110x4"	176.5	480	183.5	128	24	131	158	220

## Manicotto di riparazione

**53915**

Repair Coupling - Manchon de réparation - Manguito de reparación

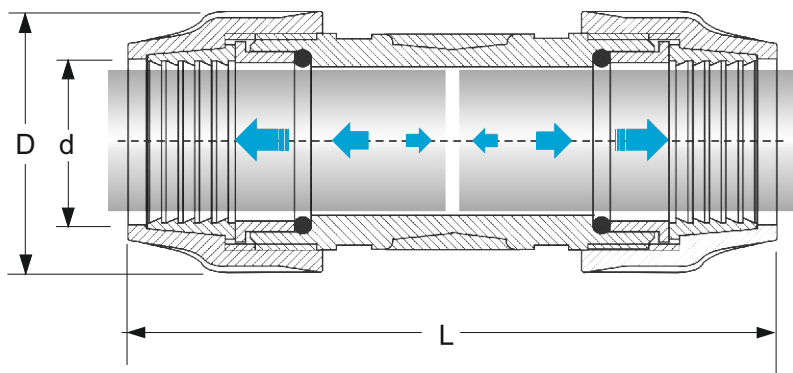

d	D	L	peso/weight (gr)
20	47	125	95
25	54	137	135
32	65	175.5	244
40	76	216.5	400
50	91.5	244	580
63	110.5	255	850
75	127.5	284	1270
90	150	344	1895
110	176.5	410.5	3150





Member of Green  
Building Council Italia



# PLASTICA ALFA

Zona Industriale C.da Santa Maria Poggiarelli s.n - 95041 CALTAGIRONE (CT) - Italy  
Tel. +39.0933.51973 - Fax +39.0933.53049  
comunicazione@plasticalfa.it - exportdpt@plasticalfa.it - www.plasticalfa.it

*absolutely made in italy*

