



**PLASTICA ALFA**  
INNOVATION & WATER TECHNOLOGIES

# RACCORDI PORTAGOMMA E MICRORACCORDERIA

Barbed and Microfittings

Technical Catalogue



## Istruzioni per il montaggio - Assembly Instructions:

1. Tagliare il tubo
2. Inserire il raccordo nel tubo fino ad arrivare alla battuta

- 
1. Cut the pipe
  2. Insert the fitting into the pipe and push it to the beat



## Materiali - Materials:

Art.: 12010 - 12011 - 14130 -15120		ABS
Art.: 13010	Ø 16 - 20 Ø 16 - 90	ABS Polipropilene/polypropylene
Art.: 12014 - 12013 - 12015 - 12016 - 12040 - 12041 - 13020 - 14010 - 14020 - 14030 - 15010 - 16055 - 16053		Polipropilene/polypropylene
Art.: 12020		A - Polipropilene/polypropylene B - Poliammide - polyamide
Art.: 12030		A - ABS B - Poliammide - polyamide
Gommino termoplastica/thermoplastic rubber		Gomma termoplastica thermoplastic rubber

## Norme di riferimento - Reference standards

UNI EN 10226-1,-2:2006

## Derivazione con manicotto (a corpo unico)

Art. 12010

Offtake for PE pipes

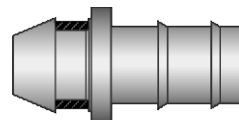
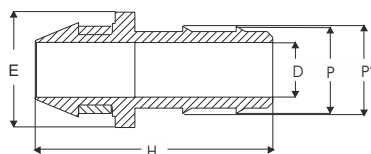

Ø	H	P	P'	D	E
16	45	15.5	15.5	10	22
20	48	18.5	19	12	22

## Derivazione a corpo unico per tubo PVC

Art. 12011

Offtake for PVC pipes

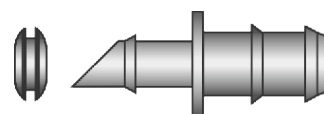
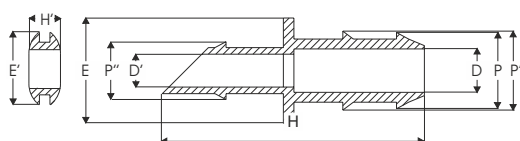

Ø	H	H'	P	P'	P''	D	D'	E	E'
16	47.5	8.5	15.5	15.5	11	10	6	19	18.5
20	47.5	8.5	18.5	19	11	12	6	19	18.5

## Derivazione per tubo PE

Art. 12014

Offtake for PE pipes

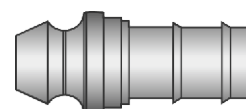
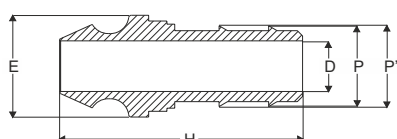

Ø	H	P	P'	D	E
16	47	15.5	15.5	10	19

**Tappo con gommino**

**Art. 12013**

Plug with rubber

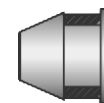
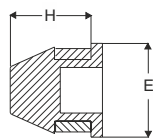

H	E
18	18

**Derivazione con gommino (per tubo PE)**

**Art. 12015**

Offtake with rubber for PE pipes

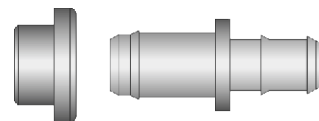
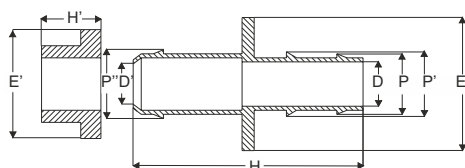

Ø	H	H'	P	P'	P''	D	D'	E	E'
16	56	15	15.5	15.5	17	10	12	23	27
20	59	15	18.5	19	18	12	12	23	27

**Derivazione con gommino (per tubo PVC)**

**Art. 12016**

Offtake with rubber for PVC pipes

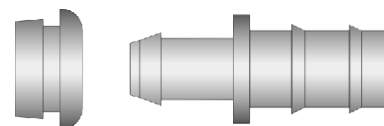
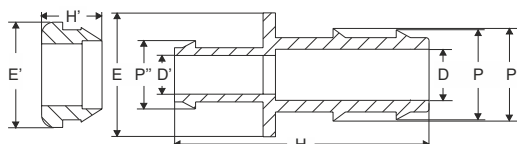

Ø	H	H'	P	P'	P''	D	D'	E	E'
16	49.5	14	15.5	15.5	14.5	10	9.5	22	24.5
20	47	14	18.5	19	15	14	10	21	24.5

## Staffetta per derivare (da tubo in PE)

Art. 12020

Connecting saddle for PE pipes

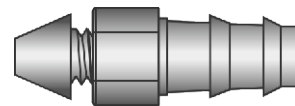
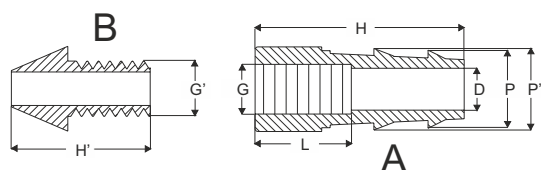

Ø	H	H'	P	P'	D	G	G'	L
16	37	24.5	15.5	15.5	8	9	10	16

## Doppia derivazione (tipo A/7)

Art. 12030

Double offtake type A/7

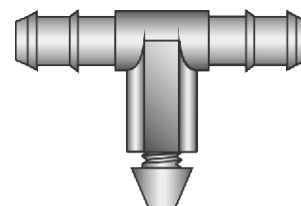
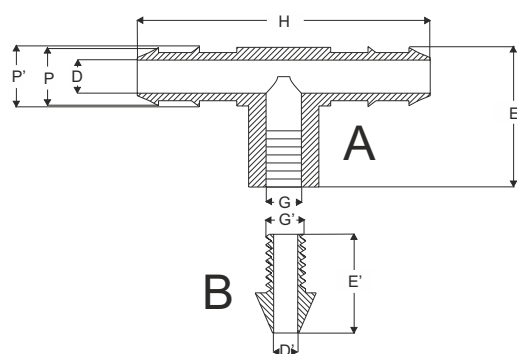

Ø	H	P	P'	D	D'	E	E'	G	G'
16	72	15	16.2	8	6	35	25	8	10

## Derivazione filettata (a corpo unico per tubo PE)

Art. 12040

Threaded offtake for PE pipes

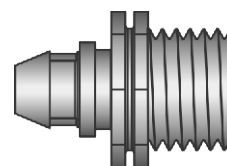
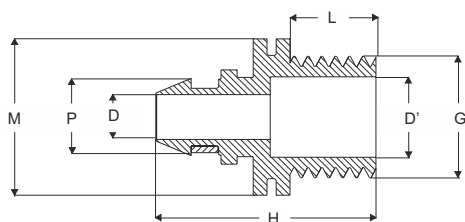

Ø	H	P	D	D'	M	G	L
1/2"	47.5	16.5	10	14	25	1/2"	17
3/4"	49	17	10	17.5	31	3/4"	19

**Derivazione filettata (a corpo unico per tubo in PVC)**

**Art. 12041**

Threaded offtake for PVC pipes

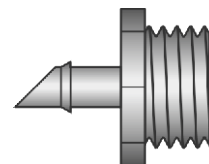
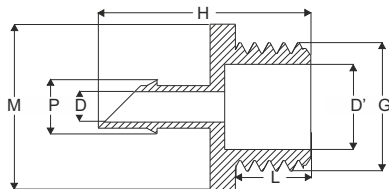

Ø	H	P	D	D'	M	G	L
3/4"	44	11	6	16.5	30	3/4"	15.5

**Manicotto**

**Art. 13010**

Coupling

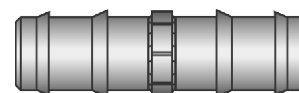
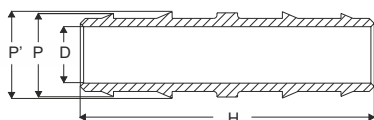

Ø	H	P	P'	D
16	52	15.5	15.5	10
20	53	18.5	19	13.5
25	89	24.9	25.7	17
32	88	31.8	32.5	23
40	87	38.9	39.9	28
50	131	46.7	47.4	38
63	166.5	59	59	49
75	186.5	68.5	69	59
90	190	83	83.2	68

**Manicotto ridotto**

**Art. 13020**

Reducing coupling

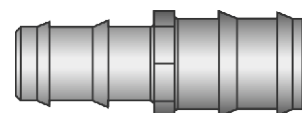
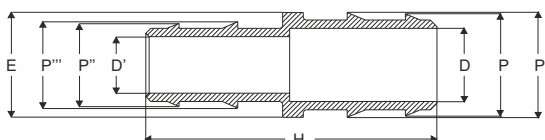

Ø	H	P	P'	P''	P'''	D	D'	E
20 X 16	52	18.5	19	15.5	15.5	14	10	21
25 X 16	82	24.9	25.7	15.5	15.5	17.5	10	23
25 X 20	88	24.9	25.7	18.5	19	17	12	23.5
32 X 25	88	31.8	32.5	24.9	25.7	22	17	29
40 X 32	86.5	38.9	39.9	31.8	32.5	28	22	36

## T a 90° a portagomma

**Art. 14010**

90° barbed tee

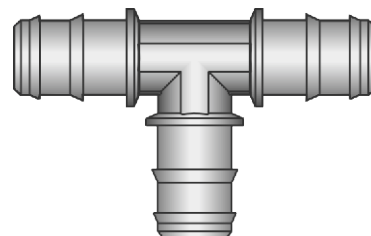
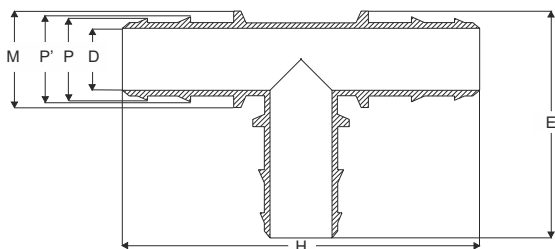

Ø	H	P	P'	D	M	E
16	64	15	16.2	10	13	39
20	98	19	20	14	23	60
25	104	23.8	24.7	19	28	66
32	120	30.9	31.7	24	31.5	75
40	135	37.4	38	29	38	85
50	145	46.2	47.5	39	49	97
63	252	59	59.2	49	57	155
75	270	69	69.3	58	67	168
90	289	82.5	82.8	68	80	186

## T a 90° ridotto

**Art. 14020**

90° reducing tee

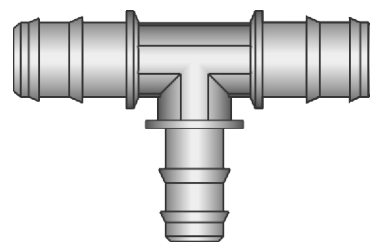
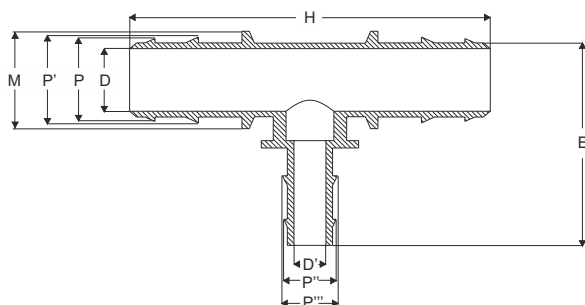

Ø	H	P	P'	P''	P'''	D	D'	M	E
16 x 20 x 16	71	15	16.2	19	20	10	14	16	54
20 x 16 x 20	99	19	20	15	16.2	14	10	23	54
20 x 25 x 20	98	19	20	24	25	14	18	23	58
25 x 16 x 25	104	23.8	24.7	15	16.2	18	10	28	58
25 x 20 x 25	104	23.8	24.7	19	20	18	14	28	63
25 x 32 x 25	105	23.8	24.7	30.9	31.7	18	23	28	68
32 x 16 x 32	120	30.9	31.7	15	16.2	23	10	32	66
32 x 20 x 32	120	30.9	31.7	19	20	23	14	32	69
32 x 25 x 32	120	30.9	31.7	24	25	23	18	32	69
32 x 40 x 32	120	30.9	31.7	37.4	38	24	30	31	77
40 x 32 x 40	136	37.4	38	30.9	31.7	30	23	38	81

## T a 90° (con derivazione filettata maschio)

Art. 14030

90° male threaded tee

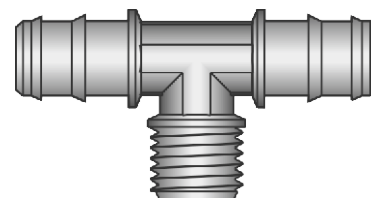
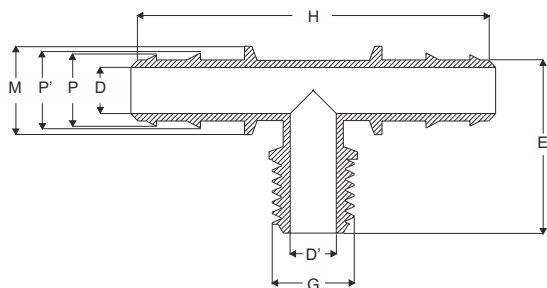

Ø	H	P	P'	D	D'	M	E	G
16 x 1/2" x 16	71	15	16.2	10	14	16	40	1/2"
16 x 3/4" x 16	71	15	16.2	10	17.5	16	41	3/4"
20 x 1/2" x 20	100	19	20	13	14	23	48	1/2"
20 x 3/4" x 20	100	19	20	13	17.5	23	55	3/4"
25 x 1/2" x 25	106	23.8	24.7	18	14	16	52	1/2"
25 x 3/4" x 25	104	23.8	24.7	18	17.5	28	53	3/4"
25 x 1" x 32	104	23.8	24.7	18	24	28	61	1"
32 x 1" x 32	120	30.9	31.7	24	24	31	59	1"
32 x 1 1/4" x 32	120	30.9	31.7	24	31	31	68	1 1/4"
40 x 1" x 40	137	37.4	38	31	24	38	65	1"
40 x 1 1/4" x 40	137	37.4	38	31	31	38	69	1 1/4"
40 x 1 1/2" x 40	137	37.4	38	31	39	38	75	1 1/2"
50 x 1 1/4" x 50	145	46.2	47.5	39	39	47	75	1 1/4"
50 x 1 1/2" x 50	145	46.2	47.5	39	39	47	75	1 1/2"



## Portagomma filettato maschio

**Art. 15010**

Male threaded barbed fitting

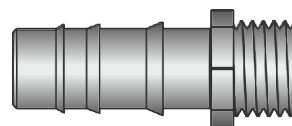
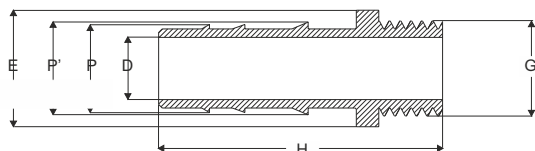

Ø	H	P	P'	D	E	G
16 x 1/2"	51	15.5	15.5	10	25	1/2"
16 x 3/4"	52	15.5	15.5	10	31	3/4"
20 x 1/2"	51	18.5	19	13	25	1/2"
20 x 3/4"	53	18.5	19	13	31	3/4"
25 x 1/2"	83	24.9	25.7	17	24	1/2"
25 x 3/4"	83	24.9	25.7	17	30	3/4"
25 x 1"	83	24.9	25.7	17	35	1"
32 x 1"	83	31.8	32.5	23	35	1"
40 x 1"	84	38.9	39.9	26	35	1"
40 x 1"1/4	84	38.9	39.9	26	43	1"1/4
40 x 1"1/2	84	38.9	39.9	26	51	1"1/2
50 x 1"1/2	84	46.7	47.4	37	51	1"1/2
63 x 2"	115	59	59	48	65	2"
75 x 2"	131	68.5	69		80	2"
75 x 2"1/2	131	68.5	69	60	80	2"1/2
90 x 2"	140	83	83.2	72	80	2"
90 x 3"	130	83	83.2	69	91	3"

**Gomito a 90°**

**Art. 16055**

90° elbow

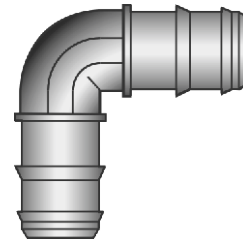
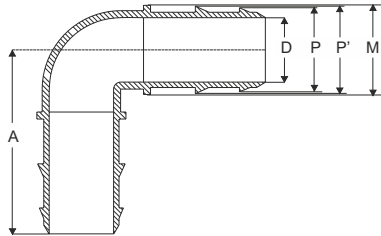

Ø	P	P'	D	M	A
16	15	16.2	10	22	39
20	19	20	14	23	49
25	23.8	24.7	18	27	52
32	30.9	31.7	24	31.5	60
40	37.4	38	31	38	67
50	46.2	47.5	39.5	49	
63	59	59.2	49	57	127
75	69	69.3	60	67	138
90	82.5	82.8	69	79	145

**Gomito a 90° Filettato maschio**

**Art. 16053**

90° male threaded elbow

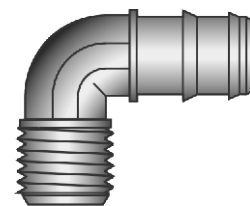
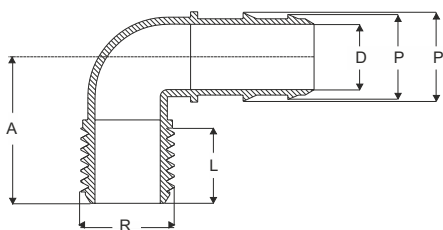

Ø	P	P'	D	A	R	L
16 x 1/2"	15	16.2	10	33	1/2"	16
16 x 3/4"	15	16.2	10	32	3/4"	17
20 x 1/2"	19	20	14	38	1/2"	21
20 x 3/4"	19	20	14	37	3/4"	21.5
25 x 1/2"	23.8	24.7				
25 x 3/4"	23.8	24.7	18	41	3/4"	20
25 x 1"	23.8	24.7	18	50	1"	21
32 x 1"	30.9	31.7	23	44	1"	19
32 x 1 1/4"	30.9	31.7	23	53	1 1/4"	21
40 x 1"	37.4	38	30	57	1"	21
40 x 1 1/4"	37.4	38	30	48	1 1/4"	21

39.5

## Raccordo a Y

Art. 14130

Y fitting

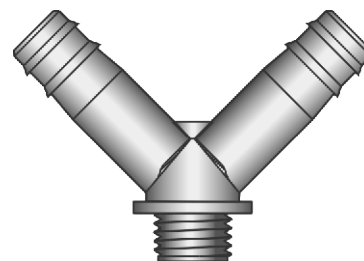
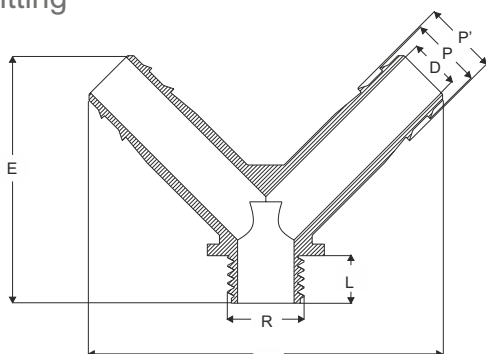

Ø	E	P	P'	D	R	L
3/4" X25X25	87	24.9	25.7	9	3/4"	86
1" X25X25	87	24.9	25.7	9	3/4"	92
1" X32X32	95	31.8	32.5	17	1"	92
1"1/4X32X32	87	31.8	32.5	23	3/4"	97

## Giunto a portagomma con ghiera filettata

Art. 15120

Barbed fitting with nut connection

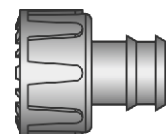
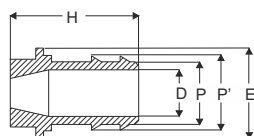
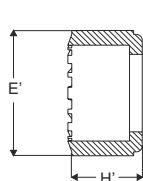

Ø	H	H'	P	P'	D	E	E'
3/4" X12	33	19	11	12	7	23	31
3/4" X16	33	19	15.5	15.5	10	23	31
3/4" X20	33	19	18.5	19	12	23	31

Micro raccorderia ed accessori - Micro fittings and accessories

**Istruzioni per il montaggio - Assembly Instructions:**

1. Inserire il tubo ed il microraccordo nella pinza (pinza per l'inserimento delle olivette)
2. Eseguire un foro nella tubazione principale con l'apposita fustella
3. Connettere l'innesto alla tubazione principale

1. Insert the pipe and the fitting into the pliers (pliers to insert olivetta)
2. Punch the main line using the proper hollow punch
3. Connect the joint to the main line



**Materiali - Materials:**

Art.: 13030 - 13031 - 13032 - 13033 -  
13034 - 13035 - 16032

Resina acetica/Acetal resin

Art.: 16030 - 13050

Polipropilene/Polypropylene

## Olivetta di derivazione per tubicino in PE o PVC plastificato

Art. 13030

Olivetta with offtake for PE or plasticized PVC pipe

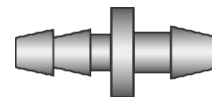
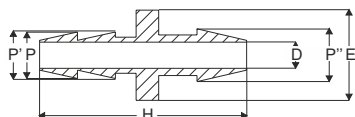

Ø	H	P	P'	P''	D	E
3.5 X 5	23	3	3.5	5	3	10
5 X 8	25	4.5	5	8	4	10

## Olivetta filettata

Art. 13031

Threaded olivetta

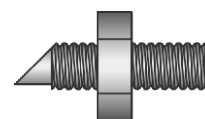
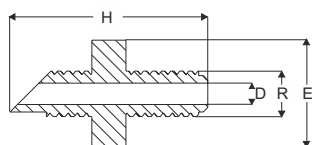

Ø	H	D	R	E
4	21	3	5	10

## Olivetta smontabile

Art. 13032

Demontable olivetta

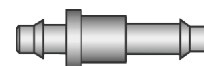
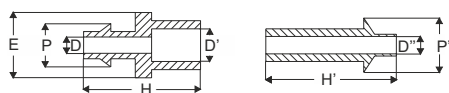

Ø	H	H'	P	P'	D	D'	D''	E
5	22	24	7	8	4	6	4	11.5

**Manicotto per tubicino PE/PVC**

**Art. 13034**

Coupling for PE or PVC pipes

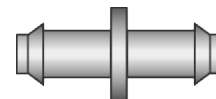
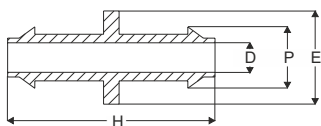

Ø	H	P	D	E
3.5	21	5	3	8
5	19	7	4	8

**Olivetta a tee**

**Art. 13035**

Tee olivetta

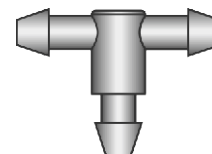
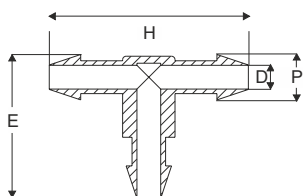

Ø	H	P	D	E
3.5	28.5	5.5	3	20

**Tappetto ad innesto**

**Art. 16030**

Small plug

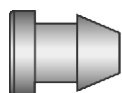
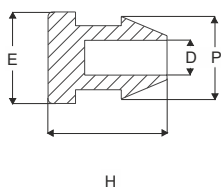

Ø	H	P	D	E
6	12	6	3	10
8	13	5	4	10
10	10	10	5	11
16	33	16	8	12

**Tappetto per olivetta**

**Art. 16032**

Plug for demontable olivetta

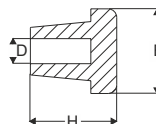

H	D	E
10	3	10

**Gancio per sostegno**
**Art. 13050**

Supporting hook for PE pipes

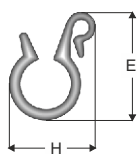

Ø	H	E
16	21	35
20	25	38
25	32	50
32		

**Astina con gancio**
**Art. 13080**

Spike with hook

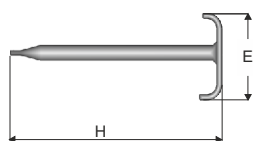

Ø	E	H
16-20	52	143

**Doppio anello**
**Art. 13060**

Double ring

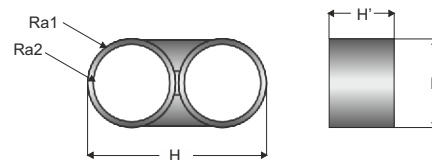

Ø	H	H'	Ra1	Ra2	E
16	42	13	11	8.5	23
20	52	14	13.5	11	27
25					

**Anello di graffaggio**
**Art. 13070**

Clinching ring

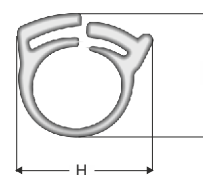

Ø	H	E
16	37	31
20	38	32



Member of Green  
Building Council Italia



# PLASTICA ALFA

Zona Industriale C.da Santa Maria Poggiarelli s.n - 95041 CALTAGIRONE (CT) - Italy  
Tel. +39.0933.51973 - Fax +39.0933.53049  
comunicazione@plasticalfa.it - exportdpt@plasticalfa.it

[www.plasticalfa.it](http://www.plasticalfa.it)

